

NEW Cellu•Sep®

FLAT SHEET MEMBRANE SQUARES for the QuixSep 5ml Dialyzers and QuixSep Micro Dialyzers Available in three Molecular Weight Cut-Offs (MWCO)

Each flat sheet measures 55mm x 55mm, with 10 sheets to a box. This amount provides 10 dialysis procedures for the QuixSep 5ml Dialyzer. **OR** ... if you are using the QuixSep Micro Dialyzers (0.1ml, 0.5ml or 1.0ml) each sheet can be cut into 4 equal pieces, providing up to 40 procedures per box. Preparation is easy... just a brief rinse in distilled water is all that is necessary for most applications.

| Part No. | Description | Quantity |
|----------|---------------------------------------|----------|
| Q5010-55 | F1 Membrane, 3.5K MWCO 55mm x 55mm | 10/pk |
| Q8010-55 | F2 Membrane, 6-8K MWCO, 55mm x 55mm | 10/pk |
| Q1210-55 | F3 Membrane, 12-14K MWCO, 55mm x 55mm | 10/pk |

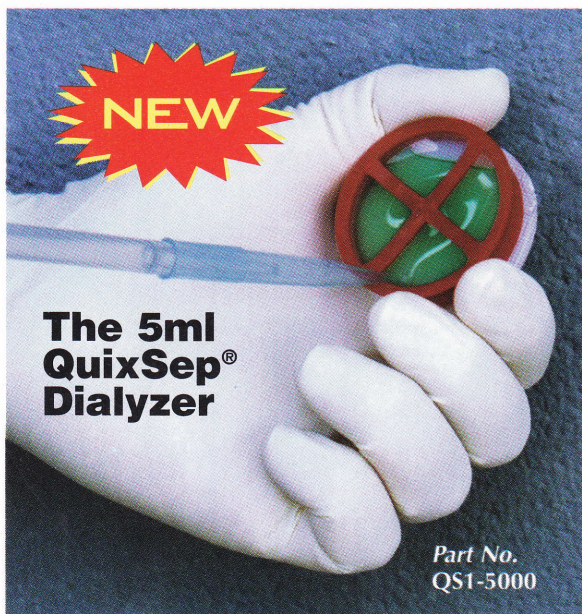

... with the same proven benefits of our QuixSep® Micro Dialyzers, only larger to suit your dialysis needs.

Part No. QS1-5000 - QuixSep 5ml dialyzer, 1/ea

- **ECONOMICAL** - Each dialyzer can be re-used hundreds of times, keeping your cost per procedure lower than any other device in the market. You can use membranes you may already have on the shelf, or our pre-cut, low-cost Cellu•Sep® brand membrane squares.
- **VERSATILE** - You are not limited to a specific MWCO, as with competitive dialyzers. You can use any membrane that is at least 55mm wide, and in any MWCO available. Membranes can even be cut from a roll of membrane tubing that you may already have on hand, as long as the membrane, when open, is at least 55mm wide. Or we can supply you with Cellu•Sep® pre-cut membrane squares in three MWCO's. (see above)
- **ENVIRONMENTALLY FRIENDLY** - No disposable cassettes or cartridges to add to your ever-expanding biohazardous waste.
- **FAST** - 15cm² membrane surface ensures a fast, complete dialysis procedure.

4 easy steps to dialysis:

1. Fill base with sample.
2. Place prepared membrane over base and push the collar over base to seal.
3. Dialyze in vigorously stirred beaker, making sure that the QuixSep is pulled below the surface, and rotates vertically in the vortex.
4. Pierce membrane with pipette tip or syringe to aspirate sample.

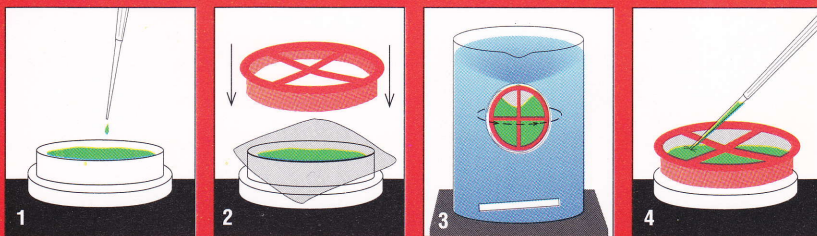

QuixSep Micro Dialyzers

| Part No. | Max. Capacity | Qty. |
|----------|---------------|-----------|
| QS1-0100 | 0.1 ml | 1 ea |
| QS1-0500 | 0.5 ml | 1 ea |
| QS1-1000 | 1.0 ml | 1 ea |
| QS3-0100 | 0.1 ml | 3 ea |
| QS3-0500 | 0.5 ml | 3 ea |
| QS3-1000 | 1.0 ml | 3 ea |
| QS3-1510 | Assorted | 1/ea size |

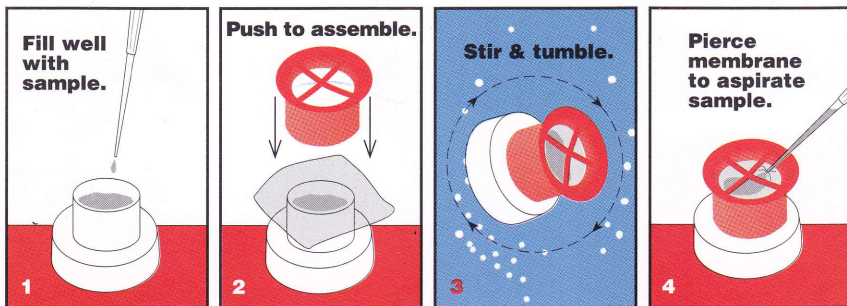

- The QuixSep method of loading and unloading sample is easy, efficient, and helps prevent sample loss.
- QuixSep's work fast – most equilibration times average 30 minutes to one hour for simple dialysis of salts or buffer exchange.
- You may choose your own membranes (and MWCO) "right off the shelf" to use with a QuixSep.
- QuixSep's are reusable and rugged, which reduces cost and minimizes bio-hazardous waste.
- QuixSep's are available in three convenient volumes: 0.1ml, 0.5ml & 1.0ml

For more information and list prices (US domestic), log onto our website at www.membrane-mfpi.com.

